

USEF/USDF # 316032, Level 3
Opening date: January 25

Saturday & Sunday

NCDCTA Recognized - www.NCDCTA.org
Closing Date: received by March 15



March Magic Dressage

March 27-28, 2021

2630 Prison Camp Road, Williamston, NC 27892

Official Qualifying Competition for the 2021 Adequan FEI North American Youth Championships; the 2021 USEF Children Dressage National Championship; the 2021 USEF Pony Rider Dressage National Championship; 2021 USEF Junior & Young Rider Dressage National Championships; 2021 Young Adult 'Brentina Cup' Dressage National Championships; 2021 Markel/USEF Young & Developing Horse Dressage National Championships; 2021 FEI World Breeding Championships for Young Horses in Dressage (Five, Six & Seven Year Olds) 2021 Great American Insurance Group/USDF Regional Qualifier, 2021 CBLM Qualifier



Horseworks Insurance Specialists \$500 added Stakes Classes
Martin County \$150 added PSG ♣ Martin County \$200 Musical Freestyle
\$200 Martin County Grand Prix
\$100 added Saturday Pro-Am Team Competition

Competition Licensee/Manager:

Sporting Services, LLC
Cassidy Sitton (618) 201-3290
ssdlcinfo@gmail.com

Secretary:

Patti Hildreth (919) 210-5899
9320 St. John's Church Road
Zebulon, NC 27597

Website: www.sportingservices.net

Online Entries: www.horseshowoffice.com

Announcer: Charlie Musco

Photographer: High Time Photography
www.hightimephotos.com



Judges:

Joan Darnell (S-WA)
Charlotte Trentelman (S-FL)
Anne Moss (R-FL)
Others TBA as needed

TD: Elizabeth Morosani (r-NC)

On Call Veterinarian: NC Mobile Veterinary Service, PLLC (919) 770-1744

EMT: Williamston Fire/Rescue (252) 792-3521

Farrier: Joe Purvis (252) 822-4723

Night Watch: Amy Struzziere
brookesedge@aol.com (845) 220-7206

Show office hours: Fri. 12:00 pm – 7:00 pm, Sat. 6:00 am – 5:00 pm, Sun. 6:00 am – end

Used Tack Sale - Friday noon to Sunday 2 pm

In accordance with North Carolina and USEF requirements, Sporting Services will be implementing the following COVID-19 Rules and Guidelines in order to keep competitors and staff/volunteers as safe as possible during this pandemic:

- ◆ Only online entries will be accepted via www.sportingservices.net using www.horseshowoffice.com All entry documentation must be submitted online via the entry portal or emailed directly to the show secretary at ssdlcinfo@gmail.com. A **penalty fee of \$10 will be added** for any entries which do not have paperwork completed and submitted by March 24 at 5:00 pm and therefore require entrants to come to the office to complete.
- ◆ Anyone who has a fever, exhibits COVID-19 symptoms, has tested positive for COVID-19 within the three weeks prior to the show or has been in contact with anyone who has tested positive to COVID-19 within the three weeks prior to the show may not enter the show grounds.
- ◆ **EVERYONE** (riders, handlers, owners, trainers, coaches, grooms, officials, staff, volunteers and any others) **must sign a current USEF Waiver Form**. Anyone entering the grounds without the signed Waiver Form will be asked to complete the form or leave the grounds. Competitors must limit the number of helpers on the grounds to one per horse. No additional spectators are allowed.
- ◆ The show office will be closed to everyone except for show staff throughout the event. Show packets will be placed at stall for complete entries. For those without complete entries, only one person at a time will be allowed in the office.
- ◆ **Face masks/coverings must be worn by everyone** on the grounds except when mounted on a horse. Masks must be worn properly, covering nose and mouth.
- ◆ The wearing of face masks/coverings, social distancing, minimal contact between staff/volunteers and competitors, temperature checks, and limited or spaced stabling will be enforced. No tables will be allowed in barn aisles.

CLASS LIST SATURDAY

Sat. #	Class Name	Divisions Offered*	Class Fee
10	USDF Intro A Opportunity ¹	Open	\$45
11	USDF Intro B Opportunity ¹	Open	\$45
12	USDF Intro C Opportunity ¹	Open	\$45
13	Training Level Test 1 Opportunity ¹	Open	\$45
14	Training Level Test 2 Opportunity ¹	Open	\$45
16	First Level Test 1 Opportunity ¹	Open	\$45
17	Second Level Test 1 Opportunity ¹	Open	\$45
101	Training Level Test 1	Open/JR/YR/AA	\$50
102	Training Level Test 2	Open/CBLM	\$50
103	Training Level Test 3 – <i>Dressage Foundation Benefit</i> ²	Open/2021 GAIG USDF Q	\$50
111	First Level Test 1	Open/JR/YR/AA	\$50
112	First Level Test 2	Open/CBLM	\$50
113	First Level Test 3	Open/2021 GAIG USDF Q	\$50
121	Second Level Test 1	Open/JR/YR/AA	\$50
122	Second Level Test 2	Open/CBLM	\$50
123	Second Level Test 3	Open/2021 GAIG USDF Q	\$50
131	Third Level Test 1	Open/JR/YR/AA	\$55
132	Third Level Test 2	Open/CBLM	\$55
133	Third Level Test 3	Open/2021 GAIG USDF Q	\$55
141	Fourth Level Test 1	Open/JR/YR/AA	\$55
142	Fourth Level Test 2	Open/CBLM	\$55
143	Fourth Level Test 3	Open/2021 GAIG USDF Q	\$55
150	FEI Prix St. Georges	Open/JR/YR/AA/CBLM/2021 GAIG USDF Q	\$65
150.1	\$\$ Martin County FEI Prix St. Georges Stakes	Open/CBLM/2021 GAIG USDF Q	\$90
151	FEI Intermediate I	Open/CBLM/2021 GAIG USDF Q	\$65
152	FEI Intermediate II	Open/CBLM/2021 GAIG USDF Q	\$65
153	FEI TOC (Int A or B, GPS)	Open	\$65
154	FEI TOC (Childrens, Jr, YR)	Jr/YR,CBLM/2021 GAIG USDF Q <i>as allowed</i>	\$65
155	\$200 Martin County FEI Grand Prix	Open/CBLM/2021 GAIG USDF Q	\$65
156	FEI Para TOC (Excludes Freestyle)	PE	\$65
157	FEI Pony TOC (Excludes Freestyle)	Open/NDPC,CBLM	\$65
160	\$\$ USDF Training Level Musical Freestyle	Open/JR/YR/AA, CBLM	\$65
161	\$\$ USDF Musical Freestyle TOC 1st, 2nd, 3rd, 4th	Open/CBLM/2021 GAIG USDF Q	\$65
162	\$\$ FEI Musical Freestyle TOC	Open;CBLM/2021 GAIG USDF Q <i>as allowed</i>	\$65
163	\$\$ FEI Junior Rider/Young Rider Freestyle TOC	Jr/YR,CBLM	\$65
165	USDF Pas de Deux TOC	Open/CBLM	\$30 ea
170	USEF Pony TOC (Training -4 th , state Q as allowed)	Open/NDPC/2021 GAIG USDF Q <i>as allowed</i>	\$55
171	USEF & FEI Young Horse TOC	Open	\$65
172	USEF Developing Horse TOC (PSG or GP) (2019 ed)	Open (PSG 7-9 YO Horses; GP 8-10 YO Horses)	\$65
173	FEI Young Rider Grand Prix Test (2019 ed)	Young Rider	\$65
174	Materiale 3, 4 & 5 YO Fillies & Mares	Open	\$50
175	Materiale 3, 4 & 5 YO Colts/Geldings/Stallions	Open	\$50
176	Dressage Seat Equitation	AA/JR/YR	\$50
180	FEI Pony Team Test	CBLM/NDPC/USEF Q	\$85
181	FEI Children Team Test	CBLM/USEF Q	\$85
182	FEI Junior Team Test	CBLM/NAYC/USEF Q/2021 GAIG USDF Q	\$85
183	FEI Young Rider Team Test	CBLM/NAYC & USEF Q/2021 GAIG USDF Q	\$85
184	FEI Intermediate II Test	CBLM/USEF Q/Brentina Cup/2021 GAIG USDF Q	\$85
193	FEI 5 Year Old Preliminary Test	USEF/FEI WBC Q	\$85
194	FEI 6 Year Old Preliminary Test	USEF/FEI WBC Q	\$85
195	FEI 7 Year Old Preliminary Test	USEF/FEI WBC Q	\$85

*For any Open class with 4 or more in a division, each division will be pinned separately.

¹No USDF/USEF memberships, Horse ID or drug fee required for Opportunity classes.

²Dressage Foundation Benefit – Special ribbons, \$250 donated to The Dressage Foundation to support TDF grants & programs.

EVERY CLASS OFFERED HEREIN IS COVERED BY THE RULES AND SPECIFICATIONS OF THE CURRENT USEF RULE BOOK AND WILL BE CONDUCTED AND JUDGED IN ACCORDANCE THEREWITH.

CLASS LIST SUNDAY

Sun. #	Class Name	Divisions Offered*	Class Fee
20	USDF Intro A Opportunity ¹	Open	\$45
21	USDF Intro B Opportunity ¹	Open	\$45
22	USDF Intro C Opportunity ¹	Open	\$45
23	Training Level Test 1 Opportunity ¹	Open	\$45
24	Training Level Test 2 Opportunity ¹	Open	\$45
26	First Level Test 1 Opportunity ¹	Open	\$45
27	Second Level Test 1 Opportunity ¹	Open	\$45
201	Training Level Test 1	Open	\$50
202	Training Level Test 2	Open/CBLM	\$50
202.1	\$\$ Horseworks Insurance Training Level Test 2	Open/CBLM	\$75
203	Training Level Test 3	Open/JR/YR/AA/2021 GAIG USDF Q	\$50
211	First Level Test 1	Open	\$50
212	First Level Test 2	Open/CBLM	\$50
212.1	\$\$ Horseworks Insurance First Level Test 2	Open/CBLM	\$75
213	First Level Test 3	Open/JR/YR/AA/2021 GAIG USDF Q	\$50
221	Second Level Test 1	Open	\$50
222	Second Level Test 2	Open/CBLM	\$50
222.1	\$\$ Horseworks Second Level Test 2	Open/CBLM	\$75
223	Second Level Test 3	Open/JR/YR/AA/2021 GAIG USDF Q	\$50
231	Third Level Test 1	Open	\$55
232	Third Level Test 2	Open/CBLM	\$55
232.1	\$\$ Horseworks Third Level Test 2	Open/CBLM	\$80
233	Third Level Test 3	Open/JR/YR/AA/2021 GAIG USDF Q	\$55
241	Fourth Level Test 1	Open	\$55
242	Fourth Level Test 2	Open/CBLM	\$55
242	\$\$ Horseworks Fourth Level Test 2	Open/CBLM	\$80
243	Fourth Level Test 3	Open/JR/YR/AA/2021 GAIG USDF Q	\$55
250	FEI Prix St. Georges	Open/JR/YR/AA/CBLM/2021 GAIG USDF Q	\$65
251	FEI Intermediate I or II TOC	Open/CBLM as allowed/2021 GAIG USDF Q	\$65
253	FEI TOC (Int A or B, GPS)	Open	\$65
255	\$\$ Martin County \$200 FEI Grand Prix	Open/CBLM/2021 GAIG USDF Q	\$65
256	FEI Para TOC (Excludes Freestyle)	PE	\$65
257	FEI Pony TOC (Excludes Freestyle)	Open/NDPC, CBLM	\$65
260	USDF Training Level Musical Freestyle	Open/JR/YR/AA/CBLM	\$65
261	USDF Musical Freestyle TOC 1 st , 2 nd , 3 rd , 4 th	Open/CBLM/2021 GAIG USDF Q	\$65
262	FEI Musical Freestyle TOC	Open, CBLM/2021 GAIG USDF Q as allowed	\$65
270	USEF Pony TOC (Training thru 4 th , state Q as allowed)	Open/NDPC/2021 GAIG USDF Q as allowed	\$55
271	USEF & FEI Young Horse TOC Practice	Open	\$65
274	Materiale 3, 4 & 5 YO Fillies & Mares	Open	\$50
275	Materiale 3, 4 & 5 YO Colts/Geldings/Stallions	Open	\$50
276	Dressage Seat Equitation Jr/YR/AA	AA/JR/YR	\$50
280	FEI Pony Individual Test	NDPC/USEF Q	\$85
281	FEI Children Individual Test	USEF Q	\$85
282	FEI Junior Individual Test	NAYC/USEF Q	\$85
283	FEI Young Rider Individual Test	NAYC/USEF Q	\$85
284	FEI Grand Prix 16-25 Test	Brentina Cup/USEF Q	\$85
285	FEI Junior Freestyle Test	NAYC & USEF Q	\$85
286	FEI Young Rider Freestyle Test	CBLM/NAYC & USEF Q	\$85
290	USEF Four-Year-Old Test	USEF/FEI WBC Q	\$85
291	USEF Developing Prix St. Georges Test (7-9 YO)	USEF/FEI WBC Q	\$85
292	USEF Developing Grand Prix Test (8-10 YO)	USEF/FEI WBC Q	\$85
293	FEI 5 Year Old Final Test	USEF/FEI WBC Q	\$85
294	FEI 6 Year Old Final Test	USEF/FEI WBC Q	\$85
295	FEI 7 Year Old Final Test	USEF/FEI WBC Q	\$85

*For any Open class with 4 or more in a division, each division will be pinned separately.

¹No USDF/USEF memberships, Horse ID or drug fee required for Opportunity classes.

EVERY CLASS OFFERED HEREIN IS COVERED BY THE RULES AND SPECIFICATIONS OF THE CURRENT USEF RULE BOOK AND WILL BE CONDUCTED AND JUDGED IN ACCORDANCE THEREWITH.

SHOW FEES:**Individual Class fees shown in Class List**

Great American/USDF qualifying (USDF-Q)	add \$ 15.00
USEF fee (D&M \$15, USEF \$8)	\$ 23.00 <i>per competing horse.</i>
USEF "showpass" non-member fee (for each NM rider, owner, trainer, coach)	\$ 45.00
USDF non-member fee (for each NM owner & rider)	\$ 35.00
USDF Affidavit Fee	\$ 5.00
Horse Stall (9 a.m. Fri. - 6 p.m. Sun., includes 2 bags bedding)	\$125.00 <i>per weekend</i>
Extra Bedding (<i>NO outside bedding allowed</i>)	\$ 8.50 <i>per bag</i> PRE-ORDERED \$ 9.50 <i>per bag</i> AT SHOW
Tack Stall	\$110.00 <i>per weekend, no bedding</i>
Layovers	\$ 55.00/ <i>night horse or tack stall</i> \$ 35/ <i>night camper</i>
Camper/RV Hookups	\$ 80.00/ <i>2 nights</i>
Day parking for non-stabled horses	\$ 30.00/ <i>horse/day</i>
Office fee	\$ 40.00 <i>per entry, non-refundable</i>
Late Paperwork Fee (for entries not complete by 3/24)	\$ 10.00
Late fee (<i>If accepted, received after closing date</i>)	\$ 40.00 <i>per entry</i>
Pro-Am Team	\$ 20.00 <i>per team of 3 or 4</i>
Guest Horse (plus stabling or day parking)	\$ 50.00 <i>per horse</i>
Class Sponsorship	\$ 25.00 <i>per class</i> \$ 40.00 <i>for USEF Q class</i>

Entries: Entries should be made online at www.horseshowoffice.com All stabling and other special requests are granted on a first come basis. Show management reserves the right to cut off entries prior to closing date if show is full. **Late paperwork penalty will be assessed for any entries that do not have all executed paperwork submitted online by March 24 at 5:00 pm and therefore must come to office to check in.** Entry packets for completed entries will be at stalls. Entry packets for completed entries for haul in horses will be on table outside of show office.

Guest Horses: (*non-competing*) Submit signed entry form, coggins, proof of vaccination, pay guest horse fee, office fee plus either stabling or day parking. Guest horses should avoid crowded warm up arenas, priority given to competing horses.

Checks: Payments by check will be accepted at www.horseshowoffice.com until closing date.

Refunds: *Before closing date*, less office fee. *After CD:* USEF fee, Q fees, & any paid extra bedding refunded for notified scratches prior to show; no refunds for no-shows. No other refunds after closing date, including classes canceled due to weather, terrorism, or Acts of God.

Bounced check policy: \$40 fee; entry wait listed until payment settled.

PayPal/Credit Card dispute: \$70 charge per dispute, chargeback and/or withdrawal.

Online Entries: No extra processing fees, see website for details. www.horseshowoffice.com

One Athlete Rule: For USEF qualifying for Children, Pony Riders, Juniors, Young Riders, Brentina Cup (Young Adults), and Young & Developing Horse divisions, within 24 hours prior and at no time during the competition, may any horse entered in a USEF Qualifying class be ridden by anyone other than the athlete entered in that class on that horse, under penalty of disqualification from the class for USEF championship qualifying purposes. Exception: grooms riding on a loose rein. For purposes of this rule, the competition starts when horse and athlete arrive on the show grounds and ends at the conclusion of the USEF licensed competition.

March Magic Dressage General Information

DEFINITIONS/ELIGIBILITY:

JR/YR – Riders are eligible to compete in these classes until the end of the calendar year in which they reach the age of 21. FEI JR Tests - only riders ages 14-18. FEI YR Tests - only riders ages 16-21. FEI Pony Tests - only riders ages 12-16. FEI Children Tests - only riders ages 12-14. Include birth date on entry.

AA – Adult Amateur – Individuals possessing current amateur certification are only eligible as AA from the beginning of the calendar year in which they turn 22. Only active USEF members may obtain amateur status.

PE – Para Equestrian – Riders must have a current USEF Dispensation Certificate which indicates their classification status to be eligible. All tests in standard arena.

CBLM – Colonel Bengt Ljungquist Memorial Championship qualifying class for 2021. Riders must be member of a participating GMO at the time of the show to be eligible.

USEF Q – Qualifying class for 2021 USEF National Championships (One Athlete Rule applies)

USEF/FEI WBC Q – Qualifying class for World Breeding Championships for 5, 6 & 7 year old horses. (One Athlete Rule applies)

USDF Q – Qualifying class for 2021 GAIG/USDF Regional Championships. Declare qualifying ride on entry form and pay additional \$15 qualifying fee prior to start of class.

NAYC & USEF Q – Qualifying class for 2021 FEI NAYC & USEF National Junior & Young Rider Championships.

Opportunity classes – No USEF/USDF memberships required, no Horse ID required. Horses entered ONLY in Opportunity classes are exempt the \$23 USEF drug fee, however these horses are still subject to D&M rules and may be drug tested at the competition.

AWARDS:

- Trophy and ribbons through sixth place in all classes.
- **PRO-AM Teams** ~ Sign up for Saturday's Team Competition! **Purse: Prizes plus \$100 prize money plus 2/3 of team fees** awarded to winning team. One pro (or "open" rider) and 2-3 JR/YR or AA will comprise a team. Top 4 scores will be averaged to determine winner. Register in show office by 9 am Saturday with \$20 per team fee. (*Intro, Material, DSE, MFS, Rider Test & Young Horse scores exempt.*)
- **The Jockey Club Thoroughbred Incentive Program (TIP)** is offering ribbon to high score Thoroughbred. Eligible horses must provide TIP numbers (free) to show office. www.tjctip.com
- **National Dressage Pony Cup:** Champion & Reserve to highest average from classes 157, 170, 180, 257, 270 & 280
- **AQHA high score:** special prize sponsored by EZIUM.
- **Saturday High Score Awards for each level** *custom prizes donated by Linda Lou's Leather*
- **High Score Adult Amateur**
- Dressage Foundation Benefit Class – special ribbons, \$250 donated The Dressage Foundation.
- **Breed High Score Awards Including:** Thoroughbred Incentive Program, Danish Warmblood, American Saddlebred, American Hanoverian, Oldenburg ISR, American Morgan Horse, NA Sport Pony & American Warmblood, Arab & Half Arab, National Dressage Pony Cup Partner, International Rescue Horse Registry; Welsh Pony sponsored by Odyssey Farm

Horseworks Insurance Specialists \$125 Added Stakes: Prize money is \$125 plus 1/3 of entry fees to be distributed as follows: Up to 5 eligible – 2 payouts (60%, 40%), 6-7 eligible – 3 payouts (47%, 33%, 20%), 8-9 eligible, - 4 payouts (40%, 30%, 20%, 10%), 10 or more eligible – 5 payouts (32%, 25%, 20%, 13%, 10%). Horse/Rider pair are only eligible to win money for one level and are not to have competed at a higher level at a USEF/USDF Recognized show prior to closing date. Prize money will be halved if less than 3 entrants eligible per division. All prize money will be paid via PayPal or checks will be mailed to owners.

Martin County \$150 Added Prix St. George Stakes (class 150) Class pinned Open/AA/Jr-Yr if entries warrant, but combined for prize money. Prize money is \$100 plus 1/3 of entry fees and will be distributed as follows: Up to 5 eligible – 2 payouts (60%, 40%), 6-7 eligible – 3 payouts (47%, 33%, 20%), 8-9 eligible, - 4 payouts (40%, 30%, 20%, 10%), 10 or more eligible – 5 payouts (32%, 25%, 20%, 13%, 10%). Horse/Rider pair not to have competed at a higher level at a USEF/USDF Recognized show prior to closing date. Prize money will be halved if less than 3 entrants eligible. All prize money will be paid via PayPal or checks will be mailed to owners.

AWARDS cont'd:

Martin County \$200 Musical Freestyle: All MFS classes on Saturday will be pinned individually. For prize money purposes: 160 and 161 will be combined for \$200 purse (\$100 first, \$75 second, \$25 third). Classes 162 and 163 will be combined for \$200 purse (\$100 first, \$75 second, \$25 third). If fewer than 3 starters in each of the two prize money divisions, the purse for that division will be halved. All prize money will be paid via PayPal or checks will be mailed to owners.

Martin County \$200 FEI Grand Prix TOC (classes 155 & 255). Must ride in both classes. High average will receive \$125 prize money, second place - \$75. If less than 3 starters, prize money will be halved. All prize money will be paid via PayPal or checks will be mailed to owners.



"Attention Competitors as of January 1, 2019, if you are a USEF competing member 18 years of age or older you are required to take the core Safe Sport training within 30 days of activating our membership. Take the Safe Sport Training at USEF.org by logging into your member dashboard."

STABLING:

Permanent 10 X 10 stalls, with sliding doors, in center-aisle barns. Double stalls are no longer available. Barns have hot water wash racks, bathrooms with showers, vending areas. 2 bales bedding included per horse stall, 0 bales per Tack stall. Extra bedding should be ordered in advance (\$8) **facility rules disallow outside bedding.** Show management **is fined for every bag of "foreign" bedding found in trash!** Please order your extra bedding with entry. Extra bedding at show will be \$9 per bag. DUE TO COVID-19 space will be provided between stabling groups and no tables will be allowed in aisles. **DO NOT USE EMPTY STALLS!** Not even to place items temporarily. You will be charged for additional stabling if anything is found in unused stalls.

CAMPING:

Full hookups, plus dump station, on grounds near stabling. Indicate rig length and breaker amp (20, 30, 50 amps available) on entry form.

Golf carts available for rent, must be reserved before show. Email manager for details.

TIMES:

- Official times available Friday March 26 outside show office. Competitor is responsible for checking ride times throughout the show. *Official ride times will be posted online by noon 3/26/2021.*
- Unofficial times posted www.SportingServices.net
- **Riders assume responsibility for checking online entry and stabling status on/around closing date to verify correct information; management not responsible for errors, omissions.**

ACCOMMODATIONS: Ask for "Horse Show" group rates at host hotels;

Holiday Inn Express: (<1 mi.) Pets allowed w/surcharge, cont. breakfast, 252-799-0100.

Hampton Inn: (2 mi.) No Pets, cont. breakfast, 252-809-1100.

DIRECTIONS:

GPS Address: [2630 Prison Camp Road, Williamston N.C. 27892](https://www.google.com/maps/place/2630+Prison+Camp+Road,+Williamston,+NC+27892)

Martin Ag Center is located just off NC 64 in Williamston, NC. (48 miles east of I-95). From NC 64, take exit 512. Turn South, SBM Ag Center is 100 yards on right.

TRAILERS: Barns A-D: Drive past main entrance, turn right on Allen Williams Road (less than ¼ mi.) for direct stabling access. Barns E-F use main entrance, keep right around coliseum. After unloading, **empty trailers park in designated places only.**

ARENAS:

Competition: One or Two indoors (depends on weather), five outdoor, all 20 X 60 m.

Warmup: One covered, four outdoor, grass and permanent round pens for lunging. All outdoor rings are sand/stone all-weather footing. Indoor rings are sand/clay composite footing, with coliseum seating.

Coliseum open for schooling Friday until 8 p.m. Saturday schooling hours: TBA, check website.

HOSPITALITY: Due to COVID 19 there will be no parties this year ☹️

Food concessions available in coliseum

VENDORS: Indoor and outdoor vendor space available, contact Cassidy Sitton.

ATTENTION COMPETITORS

Each competitor is responsible for supplying management with correct applicable numbers (USDF and USEF) for horse, owner, rider, and trainer, before the day(s) of the competition.

The scores of competitors who fail to supply correct numbers may not be counted toward national awards.



Entry Information:

Entry Information Requirements: Competitors are responsible to provide valid membership numbers on the entry form for all horse, owner, rider, and trainer names listed on the entry form. USEF and USDF registration is verified electronically if valid membership numbers are provided on the entry form. Safe Sport Training must have been completed for USEF membership to be valid. You may be asked to provide copies of your membership documents if your memberships cannot be verified for any reason.

No horse will be permitted on the grounds without a valid health certificate or proof of vaccinations (Equine Influenza Virus & Equine Herpes Virus (Rhinopneumonitis) **within 6 months prior to arriving.** Rule GR845

SAFE SPORT TRAINING is required for all **riders, owners and trainers** within 30 days of membership. If Safe Sport Training has not been completed within 30 days of membership, entries will not be accepted until proof of completion is provided. If membership is renewed during show, Safe Sport Training must be completed within 30 days or results will be nullified.

Entries must be **received** by Midnight of the closing date. Any entry still requiring a signature, payment, or copies of proof of valid membership (including Safe Sport Training) by March 25 will be considered incomplete and will incur a late paperwork penalty fee of \$10. No refunds after closing date, for any reason.

- *All fees must be paid in US funds. Fees must be paid with entry. Entries not accompanied by fees will be considered late and not entered until fees are received including any late or post entry fees. Returned checks will nullify entry until debt is satisfied. Returned check fee is \$40.*
- *Entries submitted after closing date will be considered late, see below.*
- *Numbers will not be given out until entries have been submitted to the show AND owners, riders and coaches or trainers have signed all entry blanks.*
- *Only one horse-rider combination per entry form.*
- *Management reserves the right to cut off entries prior to closing date if show is full.*

Late Entries: Late entries may be accepted after the closing date if space is available, upon payment of an additional late entry fee of \$40. All late entries must enter and pay online – email for late entry permission.

Policy for Class Changes and Filling Scratches in classes: Must be eligible for class. Must have previously entered in competition as a competing or non-competing horse.

Entry Information (cont'd):

Para-Equestrian competitors and their horses are no longer exempt from USDF memberships. Para-Equestrian competitors will now be required to have a USDF participating or group membership or a Non Member fee will apply. All horses will need a life or HID USDF membership.

Day Trailer parking: Pay per day parking fee and park in areas designated by show management.

Musical Freestyles: Music must be on good quality CD or submitted electronically with entry. Sound check will be on Friday evening or early Saturday morning, check with show office. Competitor is responsible for attending sound check to make sure music works properly and for picking up their music at the end of the show.

USEF Rule DR129.9: Except for USEF/USDF Championship classes and for FEI Pony Riders, FEI Junior, FEI Young Rider and FEI Para-Equestrian Freestyles, in order to enter a freestyle class at any level, a horse/rider combination must have received a minimum score of 63% for Training through Fourth levels and **60% for FEI levels** in the highest test of the declared freestyle level or any test of a higher level at a USEF/USDF licensed Dressage Competition, Federation Licensed or FEI recognized Dressage Competition, or "open" Dressage class (i.e. open to all breeds) at a Federation Licensed Competition held prior to the competition where the horse/rider combination is entered to ride a freestyle class. A photocopy of the test verifying eligibility, or copy of the USDF score verification, must be submitted with the entry for a freestyle class."

Numbers must be worn at all times when a horse is being walked, exercised or ridden.

Show Management reserves the right to vary or add officials and refuse any entry for a cause; to disqualify any exhibitor and/or his or her horse for cause; to cause an exhibitor to forfeit his or her ribbons and winnings for cause; to return any entry and/or stall fee before or during the show for cause; all without being liable for damage or compensation. Show management reserves the right to make any changes deemed necessary for the safe and efficient conduct of this competition.

Weather/Acts of God/Accidents or Emergency Policy: Management reserves the right to cancel any classes due to hazardous weather, Acts of God, Accidents or Emergencies. Every effort will be made to reschedule with priority given to USEF Program classes. No refunds for cancellations due to hazardous weather, Acts of God, Accidents or Emergencies.

No Shows: All "No Shows" that have not contacted the show office will be considered a scratch for the rest of the show and time slots may be filled. Exhibitors enter with this understanding and agreement.

Membership/Registration Requirements for GAIG/USDF Qualifying Classes: Riders must be current USDF Participating members & USEF members (Junior, Senior or Life) in good standing and this included Safe Sport Training. Horses must be USDF Lifetime Registered and USEF Annual or Lifetime Recorded. Horses with only an HID are not eligible. Owners must be current USDF Participating or Business members & USEF members (Junior, Senior or Life) in good standing. For current Great American/USDF Championship requirements, go to www.usdf.org/competitions/competitionschampionships/regionals/index.asp.

Great American/USDF Qualifying Classes: Please indicate that the class is to count for qualifying by placing a Q after the class number. Class fee plus additional \$15 fee must be paid prior to start of the class. Qualifying will not require a separate ride. See USDF 2021 GAIG/USDF Regional Championship Program Rules pages for membership requirements.

Show Schedule and Ride Time Conflicts: It is the responsibility of the rider to inform the management of any time conflicts as soon as possible after receiving the schedule.

Additional Stabling Information:

- **Stable Group:** Please list stable group on entry form and use only **one group name** for each stable group to ensure that your group will be stabled together.
- Stalls will be ready to use by 10:00 am on Friday.
- Any **stall changes MUST** be cleared with show office.
- Trailer-ins must pay daily grounds fee and park in designated areas.
- No exhibitor may withdraw horses from a licensed show after it has commenced, or remove them from the showgrounds without permission of the show secretary or show manager.
- **State facility requires all horses post extra negative coggins test in sleeve on stall door.**
- Lungeing in designated areas only.

Pets: Dogs must be on leashes or otherwise restrained **AT ALL TIMES** while on show grounds, including in the stable area and NO pets are allowed inside coliseum. Dog owners are solely responsible for any damages, claims, losses or actions resulting from their dogs' behaviors. Dogs should not be kenneled overnight in the stable area. Dog owners failing to comply will be issued a Yellow warning card and non-compliance may result in further USEF penalties.

USDF Statement on Animal Welfare

The United States Dressage Federation, Inc. (USDF), a federation of individual members and over 100 independent organizations throughout the United States, supports the concept of ethical treatment of animals.

Dressage is a classical method of training horses, based upon the horse's natural responses, as carried out in a gradual, planned program during which the horse's athletic abilities are improved in a systematic manner. As a result, the horse becomes capable, comfortable, and responsive in partnership with the rider without the use of force. Dressage competition at various levels of achievement is the ultimate test of the training program to determine whether the desired harmony between horse and rider has been achieved.

The rules pertaining to dressage competition prohibit the use of artificial appliances, training aids, and drugs, which would force the horse to submit. Instead, the emphasis is upon training and a cooperative partnership with the rider. Major competitions are carefully monitored to assure that there is no unnecessary force or harshness displayed.

Unlike other horse sports in which horses enter training at a relatively immature state, dressage training is usually not seriously begun until the horse is three or four. The top levels of achievement require five or more years of progressive training and it is not unusual to see horses in international competition in their late teens. This, in itself, places a premium on good care and soundness throughout the horse's life.

While supporting the concept of animal welfare in its broadest form, the United States Dressage Federation, Inc., also recognizes that it is unrealistic to ascribe human emotions and responses to the horse which in its wild state is a creature of flight, living a hard and precarious existence. Under domestication, the horse is assured of ample food, water, and shelter, as well as protection against infectious diseases and damaging parasites, thus leading a longer and healthier life with a high rate of survival.

As an educational organization, USDF has numerous programs, which teach people how to pursue the accepted, humane training methods. A program of certifying instructors also emphasizes protecting the horse's welfare in pursuit of dressage training.

United States Dressage Federation
4051 Iron Works Parkway, Lexington, KY 40511
Phone: 859-971-2277, Fax: 859-971-7722, usdressage@usdf.org, www.usdf.org

ATTENTION FREESTYLE COMPETITORS



UNITED STATES DRESSAGE FEDERATION™ Freestyle Competitor Reminders

- Submit two CDs of your music clearly labeled with your name, horse's name, bridle number, and freestyle level.
- Be present for your sound check.
- Know the rules for the level you are riding. This includes forbidden and allowed movements for your level.

Questions?

Contact freestyle@usdf.org

USEF MEMBERSHIP STATEMENT

Life, senior active and junior active members shall be eligible to participate in all classes at Regular Competitions, Eventing Competitions at the Modified Level or above and Combined Driving Competitions at the Advanced Level, Dressage, Reining and Vaulting Competitions and Endurance Rides. A nonmember may participate as a handler, rider, driver, owner, lessee, agent, coach or trainer at Regular Competitions, Eventing Competitions, Dressage Competitions, Reining Competitions and Combined Driving Competitions upon payment of a \$45 Show Pass fee. Participants in the following classes are exempted from the Requirements of this rule: 1) leadline; 2) exhibitions; 3) games and races; 4) classes for 4-H members; 5) walk trot (exception: Friesian performance FR222) and academy classes (academy classes are classes limited to horses used regularly in a lesson program); 6) USDF introductory level tests, pas de deux and quadrille classes; 7) NRHA Endorsed Reining Competitions. 8) Opportunity classes, 9) citizens of other nations who have proof, in English, of current membership in good standing of their own National Federation, 10) USEA beginner novice division; and 11) assistant handlers in Dressage Sport Horse Breeding classes.

US EQUESTRIAN FEDERATION ENTRY AGREEMENT

By entering a Federation-licensed Competition and signing this entry blank as the Owner, Lessee, Trainer, Manager, Agent, Coach, Driver, Rider, Handler, Vaultier or Longeur and on behalf of myself and my principals, representatives, employees and agents, I agree that I am subject to the Bylaws and Rules of The United States Equestrian Federation, Inc. (the "Federation") and the local rules of March Magic Dressage. I agree to be bound by the Bylaws and Rules of the Federation and of the competition. I will accept as final the decision of the Hearing Committee on any question arising under the Rules, and agree to release and hold harmless the competition, the Federation, their officials, directors and employees for any action taken under the Rules. I represent that I am eligible to enter and/or participate under the Rules, and every horse I am entering is eligible as entered. I also agree that as a condition of and in consideration of acceptance of entry, the Federation and/or the Competition may use or assign photographs, videos, audios, cable - casts, broadcasts, internet, film, new media or other likenesses of me and my horse taken during the course of the competition for the promotion, coverage or benefit of the competition, sport, or the Federation. Those likenesses shall not be used to advertise a product and they may not be used in such a way as to jeopardize amateur status. I hereby expressly and irrevocably waive and release any rights in connection with such use, including any claim to compensation, invasion of privacy, right of publicity, or to misappropriation. The construction and application of Federation rules are governed by the laws of the State of New York, and any action instituted against the Federation must be filed in New York State. See GR908.4.

MODIFIED DRESS CODE FOR RIDERS IN OPPORTUNITY CLASSES

Riders in classes and tests at all levels in Level 1 Competitions, and riders in Opportunity classes in Level 2 and Level 3 Competitions, may compete wearing breeches and shirts of any color as permitted in DR120.8. Jackets or vests of any type are allowed but not required and neckwear may be worn only if the rider chooses to compete in a riding jacket. Boots and protective headgear are required as specified in DR120.1-6. USEF DR120.5. ACCORDINGLY, JACKETS ARE NOT REQUIRED FOR ANY RIDERS IN THE OPPORTUNITY CLASSES AT THIS COMPETITION.

Fly hoods permitted for all classes (indoor and outdoor)

Fly hoods (ear covers) are permitted for all classes in order to protect horses from insects. The fly hood should be discreet in color and design and should not cover the horse's eyes. After completion of the test, the rider or his/her representative is responsible for removing the fly hood to present to the designated ring steward for inspection to ensure that nothing prohibited has been added (for example, ear plugs). USEF DR121.7



UNITED STATES DRESSAGE FEDERATION™

Regional Adult Amateur Equitation Program

The USDF Regional Adult Amateur Equitation Program recognizes adult amateurs competing in equitation and promotes correct seat, position, and use of the aids in dressage. An Adult Amateur Equitation Regional Final class presented by Big Dee's Tack and Vet Supply will be held in conjunction with each of the nine USDF Regional Dressage Championship competitions, providing adult amateurs with additional opportunity for recognition.

Adult amateurs wishing to qualify to compete in an Adult Amateur Equitation Regional Final may do so by meeting the following requirements.

Qualifying Requirements

To be eligible for the USDF Adult Amateur Equitation Regional Final class, rider must have

- a) Earned a score of 70% or higher in any dressage seat equitation class (except walk/trot) at a USEF-licensed/USDF-recognized Dressage competition within the qualifying period of the applicable regional championship.
- or*
- b) Qualified to compete in any regional dressage championship class (excluding freestyles).

Membership Requirements

- Rider must have a USDF Participating Membership at the time the qualifying score is earned, and at the time of the Regional Final class.
- Rider must be an adult amateur, in accordance with GR1306 of the USEF rules, and be designated with USEF as an adult amateur when the score is earned, and at the time of the Regional Final class.
- Owner must have a USDF Participating or Business Membership when the qualifying score is earned, and at the time of the Regional Final class.
- Horse must have a USDF Lifetime Horse Registration when the qualifying score is earned, and at the time of the Regional Final class.

The USDF Regional Adult Amateur Equitation Program rules and information can be found on the USDF [website](#).

Rev. 2/8/2019



United States Dressage Federation™

OPPORTUNITIES FOR 3-6 YEAR OLD HORSES COMPETING IN MATERIALE AND/OR USEF/FEI YOUNG HORSE TESTS

	3 YEAR OLD	4 YEAR OLD	5 YEAR OLD	6 YEAR OLD
ADEQUAN®/YEAR-END AWARDS*				
Materiale Horse of the Year Award (min. 3 scores required)	X	X	X	
USEF Four-Year-Old Award (min. 4 scores required)^		X		
FEI Five-Year-Old Award (min. 4 scores required)^			X	
FEI Six-Year-Old Award (min. 4 scores required)^				X
BREEDERS CHAMPIONSHIP SERIES**				
Materiale Championships (min. 1 score required of 72% or higher)				
Three-Year-Old Championship	X			
Four-Year-Old Championship		X		
Five-Year-Old Championship			X	

For Adequan®/USDF Year-End Awards - at the time scores are earned

- * Horse must have a USDF Lifetime Horse Registration Number (LHR)
- * Owner must have a USDF Participating (PM) or Business Membership (BM)
- * Rider must have a USDF PM
- *Competition year starts October 1 and ends September 30

For USDF Breeders Championship Series - to compete in the championships

- ** Horse must have a USDF Horse Identification Number or LHR
- ** Owner must have a USDF PM, BM or non-member number
- ** Rider must have a USDF PM
- **Competition year starts January 1 and ends December 30

^Scores earned in the USEF Four- and FEI Five- & Six-Year-Old tests are also eligible to be used towards a USDF Horse Performance Certificate

Complete Award/Championship Requirements Listed in the current *USDF Member Guide*

USEF MOTORIZED VEHICLE STATEMENT:

Minors who do not have a valid driver's license which allows them to operate a motorized vehicle in the state in which they reside will not be permitted to operate a motorized vehicle of any kind, including, but not limited to, golf carts, motorcycles, scooters, or farm utility vehicles, on the competition grounds of licensed competitions. Minors who have a valid temporary license may operate the above described motorized vehicles as long as they are accompanied by an adult with a valid driver's license. The parent/legal guardian or individual who signs the entry blank as a parent or guardian of a minor operating a motorized vehicle in violation of this rule are solely responsible for any damages, claims, losses or actions resulting from that operation. Violations of this rule will be cause for penalties against those responsible for the child committing the offense. Wheelchairs and other mobility assistance devices for individuals with disabilities are exempt from this rule. The unsafe use of personal electronic transport devices, as determined by the competition officials and management in their sole discretion, that do not require a driver's license to operate, including but not limited to segways, hover boards, and single wheeled scooters is prohibited on competition grounds. Operating such devices in areas where people gather may be deemed "unsafe use" if there is a risk of harm to others. If the operator of the device is a minor, the parent/legal guardian or individual who signs the entry blank as a parent or guardian of a minor operating the device in violation of this rule is accountable and may be subject to penalties. Wheelchairs and other mobility assistance devices for individuals with disabilities are exempt from this rule.

USEF SafeSport Requirements

- ◆ The required SafeSport Training is on the U.S. Center for SafeSport website and is free for USEF members.
- ◆ All USEF Competing Members (18 and older) are required to complete SafeSport Training within 30 days of joining or renewing USEF membership.
- ◆ The SafeSport Training requirement applies to all USEF Competing Senior Members even if competing in classes (such as USDF Intro or USEF Opportunity) where USEF membership is not required.
- ◆ Junior Members (under 18 years) are not required to complete SafeSport Training at this time.
- ◆ If SafeSport Training is not completed within 30 days of joining or renewing membership, and a completion certificate (for all three phases) presented to the show secretary on or before the first day of competition, the entry will NOT be allowed to compete.
- ◆ If SafeSport Training is not completed by USEF members and certificates provided to the show secretary on or before the first day of competition, there will be NO REFUNDS for entries. This applies to all USEF members (riders, owners, trainers or coaches) for any entry, including those classes where USEF membership is not required.
- ◆ Participants (riders, owners, trainers, coaches) who are NOT USEF members are not required to complete SafeSport Training.
- ◆ If SafeSport Training is overdue and certificates are not presented to the show secretary, or posted yet on the USEF website, the entry (horse and competitor) will be allowed to remain on the competition grounds but cannot compete.
- ◆ Riders, owners, trainers and coaches may compete within 30 days of joining or renewing USEF membership even if they haven't completed SafeSport Training but will not be allowed to compete in another show at the end of the 30 day period if they haven't yet completed the Training.
- ◆ Competitions are required to check the USEF SafeSport Ineligibility list after entries are submitted and up to the first day of competition. Competitions that allow ineligible participants to compete are subject to penalties by USEF.

ATTENTION COMPETITORS –HEADGEAR RULE FOR DRESSAGE

From the time horses are officially admitted to the competition grounds by competition management, anyone mounted on a horse at any time on the competition grounds, including non-competing riders, riders on non-competing horses, and those competing in all classes and tests, including Para-Equestrian tests, must wear protective headgear as defined by this rule and otherwise in compliance with GR801. Any rider violating this rule at any time must immediately be prohibited from further riding until such headgear is properly in place. Protective headgear is defined as a riding helmet which meets or exceeds ASTM (American Society for Testing and Materials)/SEI (Safety Equipment Institute) standards for equestrian use and carries the SEI tag. The harness must be secured and properly fitted.

USDF Membership Benefits: USDF is dedicated to education, the recognition of achievement, and promotion of dressage. For details on member benefits, including educational programs, awards, and other opportunities, refer to the *USDF Member Guide* or the USDF website at www.usdf.org.

**This
competition
is recognized
by USDF
for 2021**

Membership Requirements for USEF-licensed/USDF-recognized Competitions: Owners and riders, including foreign riders and owners who are not residents of the US, wishing to participate in a USEF-licensed/USDF-recognized competition as a rider or owner/lessee, must have either a USDF Group Membership (GM), Participating Membership (PM), or have a USDF Non-Member (NM) identification number and pay the USDF Non-Member (NM) fee. (Note: USDF Business Members can own horses but cannot compete as riders with their USDF Business Membership.)

Horses competing at USEF-licensed/USDF-recognized competitions must have either a USDF Horse Identification (HID) number or a USDF Lifetime Horse Registration (LHR). Proper credentials or verification certificates must be presented to the competition secretary.

Riders and owners wishing to participate in a USEF-licensed/USDF-recognized competition, and not able to present the competition secretary with verification of a USDF membership or NM identification, and USDF LHR or USDF HID, must complete a USDF Competition Affidavit Form and pay the \$5 affidavit filing fee. A copy of a completed affidavit form from another competition may also be used for verification purposes for up to 60 days. (Exception: Affidavits cannot be used at Great American Insurance Group/USDF Regional Dressage Championships.)

Exceptions:

- Horses competing only in Individual Breed Classes (IBCs) at DSHB competitions, sires and dams of horses in DSHB group classes, where those sires or dams are not actually competing in the same competition, horses competing only in breed restricted dressage or DSHB classes at Regular Competitions (e.g. all Arabian, all Friesian, or all Morgan classes), or in USDF Introductory Level tests, pas de deux or quadrille, are exempt from this requirement. Also exempt are horses ridden in leadline, exhibitions, games and races, classes for 4-H members, walk-trot, academy, and opportunity classes.
- Riders and owners/lessees competing only in classes which are exempt from the USDF HID requirements are also exempt from the USDF NM identification number and NM fee requirements. Also exempt are handlers of horses competing in DSHB In-Hand or Group classes.

Memberships Defined

Participating Membership (PM): A membership issued to an individual directly by USDF. The membership year is December 1 through November 30. PMs are available for 1-year (\$90), 5-years (\$360), or life (\$1,800). A USDF Youth Participating Membership (YPM) is available for individuals who have not reached their 21st birthday by December 1 of the current membership year (\$72). A PM allows the member to compete at USEF-licensed/USDF-recognized competitions and to participate as a rider and/or owner/lessee for all Adequan®/USDF Year-End Awards and the Great American Insurance Group/USDF Regional Dressage Championship program.

Group Membership (GM): A membership issued to an individual by USDF when the member name and dues are submitted to USDF through an affiliate Group Member Organization (GMO). The GM year begins December 1 and ends November 30. A GM allows the member to compete at USEF-licensed/USDF-recognized competitions and participate in the USDF Rider Awards Program and the USDF Regional Schooling Show Awards Program.

Business Membership (BM): A membership that runs December 1 through November 30 and is issued to a business or organization directly by USDF. The USDF BM (\$240) offers a wider variety of advertising benefits. BMs satisfy requirements of horse ownership only.

Non-Member (NM) Identification Number: For each USDF NM owner/lessee and USDF NM rider there will be a USDF NM fee of \$35 per competition that must be collected by the show secretary and submitted to USDF, along with the USDF Report of Fees document and the \$5 affidavit fee and Competition Affidavit Form if the person cannot provide a copy of their USDF NM card. Owners/lessees or riders exempt from the NM number requirements are also exempt from paying the USDF NM fee. If there are multiple owners of a horse and all are NMs, only one of the owners must pay the NM fee. If the horse has at least one owner who is a current USDF PM, GM, or BM there is no NM fee assessed. Competition management will be invoiced for all applicable USDF NM fees not received with the USDF post-competition paperwork, along with a report listing all USDF NMs. Competition management is then required to submit the NM fees within 30 days to the USDF. An individual with a USDF NM identification number is not eligible for any USDF membership benefits. Once a USDF NM number has been assigned, a USDF NM card can be obtained from the USDF website.

Horse Identification (HID) Number: A one-time tracking number for horses (\$35). Scores earned by a horse with an HID number will be recorded, but will NOT be counted towards Adequan®/USDF Year-End Awards. A horse with an HID number is not eligible to compete in Great American Insurance Group/USDF Regional qualifying or championship classes. An HID number can be upgraded to a Lifetime Horse Registration (LHR) for a fee of \$80. If a horse has a USDF LHR it does not need an HID number. An HID number is a one-time fee that does not need to be renewed.

Lifetime Horse Registration (LHR): A horse with an LHR (\$115) is eligible for Adequan®/USDF Year-End Awards, and eligible to compete in Great American Insurance Group/USDF Regional qualifying and championship classes, assuming requirements for the owner and rider are met. If a horse has an LHR it does not need an HID number. An LHR does not need to be renewed.

How to Join USDF

Applications for USDF Participating Membership (PM), Business Membership (BM), Horse Identification (HID) number, and Lifetime Horse Registration (LHR) may be found in the following locations:

- On the USDF website: www.usdf.org. You can submit the application online or download the form and fax or mail it to the USDF office.
- In the show office at USEF-licensed/USDF-recognized competitions classified by USEF as Dressage Competitions, and Regular Competitions which are open to all breeds.
- By calling or writing the USDF office at (859) 971-2277, 4051 Iron Works Parkway, Lexington, KY 40511

The effective date of membership is the date the form and correct fees are received in the USDF office or, if applying at a competition, the date accepted by the competition secretary, provided the application is signed and dated by the competition secretary, member, and/or horse owner on that same day.

2021

Official Use Only
BRIDLE #

COMPETITION NAME _____ COMPETITION DATES _____

NAME OF HORSE		PREVIOUS NAME (IF ANY)		USEF#	USDF#	FOR SALE
BREED	SEX	HEIGHT	COLOR	COGGINS DATE (ENCLOSED COPY)	SIRE	DAM
DAM'S SIRE		COUNTRY OF BIRTH	YEAR OF BIRTH	BREEDER	FEI/PASSPORT #	GROOM

RIDER/HANDLER _____

USEF# _____ USDF# _____ FEI/LOCAL# _____

ADDRESS _____

CITY/ST/ZIP _____

CELL PHONE _____ JR/YOUNG RIDER BIRTHDAY _____

EMAIL ADDRESS _____

RIDER CITIZENSHIP (IF NOT USA) _____

RIDER STATUS (CIRCLE ONE): JR/YG AA OPEN

OWNER _____

USEF# _____ USDF# _____ LOCAL# _____

ADDRESS _____

CITY/ST/ZIP _____

CELL PHONE _____

EMAIL ADDRESS _____

OWNER CITIZENSHIP (IF NOT USA) _____

TRAINER _____

USEF# _____ USDF# _____ LOCAL# _____

ADDRESS _____

CITY/ST/ZIP _____

CELL PHONE _____

EMAIL ADDRESS _____

COACH _____

USEF# _____ USDF# _____ LOCAL# _____

ADDRESS _____

CITY/ST/ZIP _____

Please complete all three pages. Reverse MUST be SIGNED.

CLASS No.	DIVISION	CLASS DESCRIPTION	QUAL Y/N	FEES

SUBTOTAL CLASS FEES AND QUALIFYING FEES		
USEF Show Pass FEES	\$45 PER NON-MEMBER	
USDF NON MEMBER FEE	\$35 PER NON-MEMBER	
OFFICE FEE AND/OR BRIDLE # FEE		
USEF HORSE FEES	\$8 USEF FEE + \$15 DRUG FEE = \$23.00	
CDI HORSE FEES	\$8 USEF FEE + \$25 DRUG FEE = \$33.00	
IHP DISCIPLINE FEE (\$35 IF REQUIRED)		
STABLING FEES	____ STALL @ \$____/STALL	
TACK STALLS	____ STALL @ \$____/STALL	
BEDDING	____ BALES @ \$____/BALE	
NON COMPETING HORSE FEE		
SPONSORSHIP		
GROUNDS FEE OR OTHER FEES	_____	
OTHER	_____	
LATE/CHANGE/BANK CHARGES FOR CC		
TOTAL FEES		

Stabling Information & Special Requests: Please list only ONE name (either individual or barn) for entire group (so we can get everyone together)

Group/Self	Tue	Wed	Thu	Fri	Sat	Sun	Mon
Stalls							
Tack Stalls							

Stable Group: _____ Contact: _____

I hereby agree to release, indemnify and hold harmless USDF, its instructors, officers, directors, agents, and volunteers from and against any and all loss, liability or damage arising from or because of, or in connection with, participation in this competition or related activities. I also hereby agree to release, indemnify and hold harmless the competition licensee, show management, competition staff, show committee and members, officers, directors, agents, and volunteers from and against any and all loss, liability or damage arising from or because of, or in connection with, participation in this competition or related activities.



FEDERATION ENTRY AGREEMENT

By entering a Federation-licensed Competition and signing this entry blank as the Owner, Lessee, Trainer, Manager, Agent, Coach, Driver, Rider, Handler, Vaultor or Longeur and on behalf of myself and my principals, representatives, employees and agents, I agree that I am subject to the Bylaws and Rules of The United States Equestrian Federation, Inc. (the "Federation") and the local rules of March Magic Dressage (Competition). I agree to be bound by the Bylaws and Rules of the Federation and of the competition. I will accept as final the decision of the Hearing Committee on any question arising under the Rules, and agree to release and hold harmless the competition, the Federation, their officials, directors and employees for any action taken under the Rules. I represent that I am eligible to enter and/or participate under the Rules, and every horse I am entering is eligible as entered. I also agree that as a condition of and in consideration of acceptance of entry, the Federation and/or the Competition may use or assign photographs, videos, audios, cable - casts, broadcasts, internet, film, new media or other likenesses of me and my horse taken during the course of the competition for the promotion, coverage or benefit of the competition, sport, or the Federation. Those likenesses shall not be used to advertise a product and they may not be used in such a way as to jeopardize amateur status. I hereby expressly and irrevocably waive and release any rights in connection with such use, including any claim to compensation, invasion of privacy, right of publicity, or to misappropriation. The construction and application of Federation rules are governed by the laws of the State of New York, and any action instituted against the Federation must be filed in New York State. See GR908.4.

BY SIGNING BELOW, I AGREE to be bound by all applicable Federation Rules and all terms and provisions of this entry blank and all terms and provisions of this Prize List. If I am signing and submitting this Agreement electronically, I acknowledge that my electronic signature shall have the same validity, force and effect as if I affixed my signature by my own hand.

RIDER/DRIVER/HANDLER/VAULTER/LONGEUR (mandatory)

Signature: _____

Print Name: _____

TRAINER (mandatory)

Signature: _____

Print Name: _____

OWNER/AGENT (mandatory)

Signature: _____

Print Name: _____

COACH (if applicable)

Signature: _____

Print Name: _____

Parent/Guardian Signature: (Required if Rider/Driver/Handler/Vaultor/Longeur is a minor) _____

Print Parent//Guardian Name: _____ Emergency Contact Phone No. _____

Is Rider/Driver/Vaultor a U.S. Citizen: Yes No

VISA AMEX CARD NO. _____ - _____ - _____ - _____ EXP DATE _____

MasterCard Other _____ NAME ON CARD: _____ CVV # _____

BILLING ADDRESS _____ ZIP CODE _____



WAIVER AND RELEASE OF LIABILITY, ASSUMPTION OF RISK AND INDEMNITY AGREEMENT

For and in consideration of United States Equestrian Federation, Inc. dba US Equestrian ("USEF") allowing me, the undersigned, to participate in any capacity (including as a rider, driver, handler, vaulter, longeur, lessee, owner, agent, coach, official, trainer or volunteer) in a USEF sanctioned, licensed or approved event or activity, including but not limited to equestrian clinics, practices, shows, competitions and related or incidental activities and March Magic Dressage ("USEF Event" or "USEF Events"); I, for myself, and on behalf of my spouse, children, heirs and next of kin, and any legal and personal representatives, executors, administrators, successors,, and assigns, hereby agree to and make the following contractual representations pursuant to this Agreement (the "Agreement"):

A. RULES AND REGULATIONS: I hereby agree to be bound and abide by the rules, regulations, and policies of USEF as published in the USEF Rule Book and on the website at www.usef.org, as amended from time to time.

B. ACKNOWLEDGMENT OF RISK: I knowingly, willingly, and voluntarily acknowledge the inherent risks associated with the sport of equestrian and know that horseback riding and related equestrian activities are inherently dangerous, and that participation in any USEF Event involves risks and dangers including, without limitation, the potential for serious bodily injury (including broken bones, head or neck injuries), sickness and disease (including communicable diseases), trauma, pain & suffering, permanent disability, paralysis and death; loss of or damage to personal property (including my mount & equipment) arising out of the unpredictable behavior of horses; exposure to extreme conditions and circumstances; accidents involving other participants, event staff, volunteers or spectators; contact or collision with other participants and horses, natural or manmade objects; adverse weather conditions; facilities issues and premises conditions; failure of protective equipment (including helmets); inadequate safety measures; participants of varying skill levels; situations beyond the immediate control of the USEF Event organizers and competition management; and other undefined, not readily foreseeable and presently unknown risks and dangers ("Risks").

EQUINE ACTIVITY LIABILITY ACT WARNING:

CAUTION: HORSEBACK RIDING AND EQUINE ACTIVITIES CAN BE DANGEROUS. RIDE AT YOUR OWN RISK.

Under the laws of most States, an equine activity sponsor or equine professional is not liable for any injury to, or the death of, a participant in equine activities resulting from the inherent risks of equine activities.

C. ASSUMPTION OF RISK: I understand that the aforementioned Risks may be caused in whole or in part or result directly or indirectly from the negligence of my own actions or inactions, the actions or inactions of others participating in the USEF Events, or the negligent acts or omissions of the Released Parties defined below, and I hereby voluntarily and knowingly assume all such Risks and responsibility for any damages, liabilities, losses, or expenses that I incur as a result of my participation in any USEF Events. I also agree to be responsible for any injury or damage caused by me, my horse, my employees or contractors under my direction and control at any USEF Event.

D. WAIVER AND RELEASE OF LIABILITY, HOLD HARMLESS AND INDEMNITY: In conjunction with my participation in any USEF Event, I hereby release, waive and covenant not to sue, and further agree to indemnify, defend and hold harmless the following parties: USEF, USEF Recognized Affiliate Associations, the United States Olympic & Paralympic Committee (USOPC), USEF clubs, members, Event participants (including athletes/riders, coaches, trainers, judges/officials, and other personnel), the Event owner, licensee, and competition managers; the promoters, sponsors, or advertisers of any USEF Event; any charity or other beneficiary which may benefit from the USEF Event; the owners, managers, or lessors of any facilities or premises where a USEF Event may be held; and all directors, officers, employees, agents, contractors, and volunteers of any of the aforementioned parties (**Individually and Collectively, the "Released Parties" or "Event Organizers"**), with respect to any liability, claim(s), demand(s), cause(s) of action, damage(s), loss, or expense (including court costs and reasonable attorney fees) of any kind or nature ("**Liability**") which may arise out of, result from, or relate in any way to my participation in the USEF Events, including claims for Liability caused in whole or in part by the negligent acts or omissions of the Released Parties.

E. COMPLETE AGREEMENT AND SEVERABILITY CLAUSE: This Agreement represents the complete understanding between the parties regarding these issues and no oral representations, statements or inducements have been made apart from this Agreement. If any provision of this Agreement is held to be unlawful, void, or for any reason unenforceable, then that provision shall be deemed severable from this Agreement and shall not affect the validity and enforceability of any remaining provisions.

I HAVE CAREFULLY READ THIS DOCUMENT IN ITS ENTIRETY, UNDERSTAND ALL OF ITS TERMS AND CONDITIONS, AND KNOW IT CONTAINS AN ASSUMPTION OF RISK, RELEASE AND WAIVER FROM LIABILITY, AS WELL AS A HOLD HARMLESS AND INDEMNIFICATION OBLIGATIONS.

By signing below, I (as the participant or as the Parent/Legal Guardian of the minor identified below) hereby accept and agree to the terms and conditions of this Agreement in connection with my (or the minor's) participation in any USEF Event. If, despite this Agreement, I, or anyone on my behalf or the minor's behalf, makes a claim for Liability against any of the Released Parties, I will indemnify, defend and hold harmless each of the Released Parties from any such Liabilities as the result of such claim.

The parties agree that this agreement may be electronically signed. The parties agree that the electronic signatures appearing on this agreement are the same as handwritten signatures for the purposes of validity, enforceability, and admissibility.

RIDER/DRIVER/HANDLER/VAULTER/LONGEUR OWNER TRAINER OFFICIAL STAFF VOLUNTEER COACH (IF APPLICABLE)

Signature: _____ Date: _____

Print Name: _____

Parent/Guardian Signature: (Required if Rider/Driver/Handler/Vaulter/Longeur is a minor) _____ Date: _____

Print Parent//Guardian Name: _____ Emergency Contact Phone No. _____

USEF Competition Name:
Competition Division(s) and Rating(s):

USEF#:

FINALLY, THE INSURANCE YOU NEED AT A PRICE YOU CAN AFFORD



HEALTH & INSURANCE BENEFITS

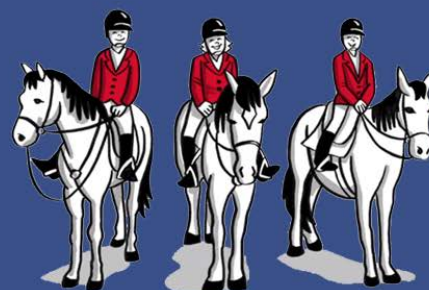

Now with just a few clicks, you can purchase the valuable coverage you and your family need.

You deserve the peace of mind that comes with having affordable, easy-to-understand benefits for you and your family. Now with your paid-fan or competing **USEF Membership**, you can sign up for a range of benefits from well-known, established insurance companies, with savings up to 35% or more!

You Can Get Coverage For...



Individual/
Family Health
Insurance



Teledoc



Global Health
Insurance



Personal Liability,
Death & Disability
Insurance



Group Health
Insurance



Free Mental
Health First Aid



Ground & Air
Ambulance



Financial
Lock



Dental, Vision, Disability, Accident,
Critical Illness, and Life Insurance



Farm, Equine, & Pet Insurance

 These benefits can be customized for individuals, families, business owners, executives, and your employees

Visit **USEF.org/insurance** to learn more and find your rate today.
Or call us at **(800) 349-1082** to speak with your USEF benefits team.



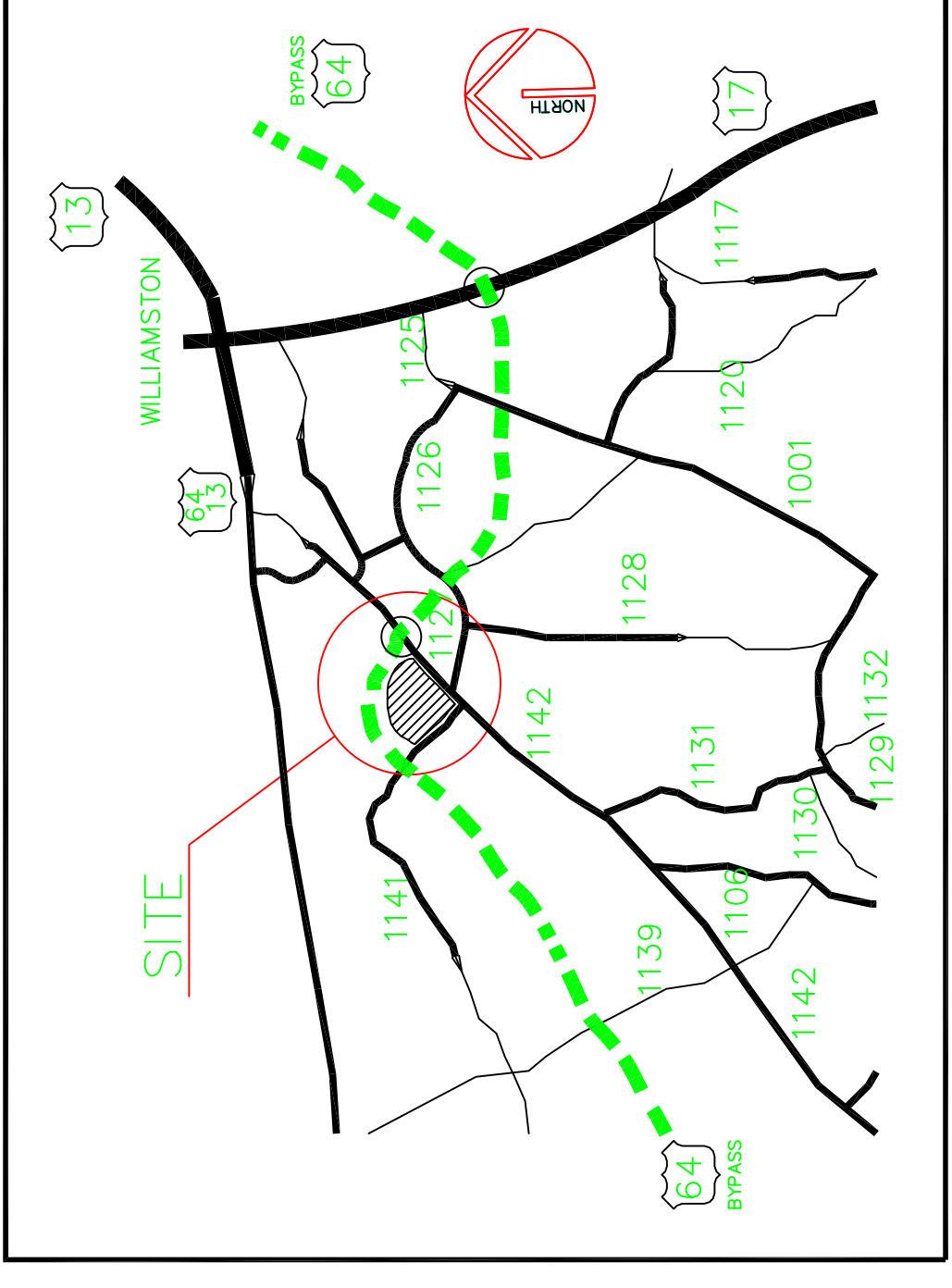

VICINITY MAP
NOT TO SCALE

BUILDING/FEATURE KEY:

- ① MAIN COLISEUM – (150' x 300')
- ② MEETING CENTER
- ③ OPEN PRACTICE RING #1
- ④ OPEN PRACTICE RING #2
- ⑤ COVERED RING #3 – (120' x 240')
- ⑥ OPEN PRACTICE RING #3
- ⑦ UNIT #1 – BARN "A"
- ⑧ UNIT #1 – BARN "B"
- ⑨ UNIT #2 – BARN "C"
- ⑩ UNIT #2 – BARN "D"
- ⑪ BARNMASTER FARRIER BUILDING
- ⑫ UNIT #3 – BARN "E"
- ⑬ UNIT #3 – BARN "F"
- ⑭ MAINTENANCE AREA
- ⑮ DRESSAGE PAD – (350' X 170')
- ⑯ EAST BUILDING – (100' X 240')
- ⑰ LUNGING RING – (60')

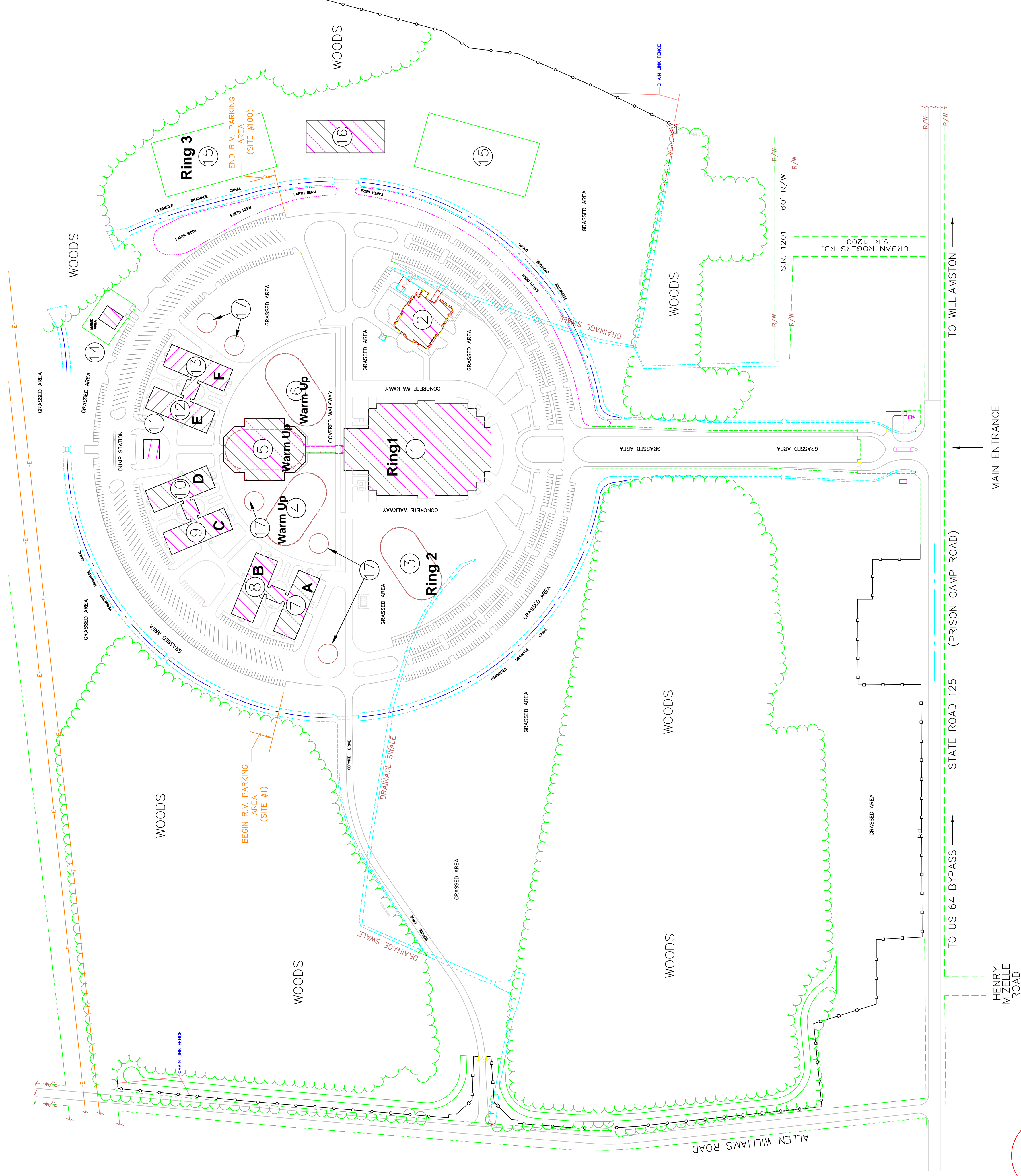

SITE PLAN
SENATOR BOB MARTIN
EASTERN AGRICULTURAL CENTER
WILLIAMSTON, NORTH CAROLINA

NOT TO SCALE

TOTAL AREA
7,373,306 +/- sq.ft
169.23 +/- acres

